

User Profile

The User Profile icon provides users access to various features and settings, enhancing their experience. Changes in this area only affect the individual user, not others from their health center using the solution.

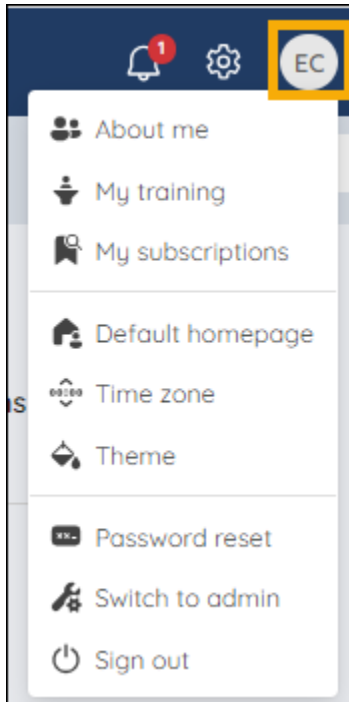

Security

The Security section provides the user with the ability to reset their password.

Password reset

The Password reset feature enables users to reset their passwords easily. Use it to update the password for security reasons, ensuring secure access to your account.

1. Navigate to the **User Profile** menu.
2. Click **Password reset**.

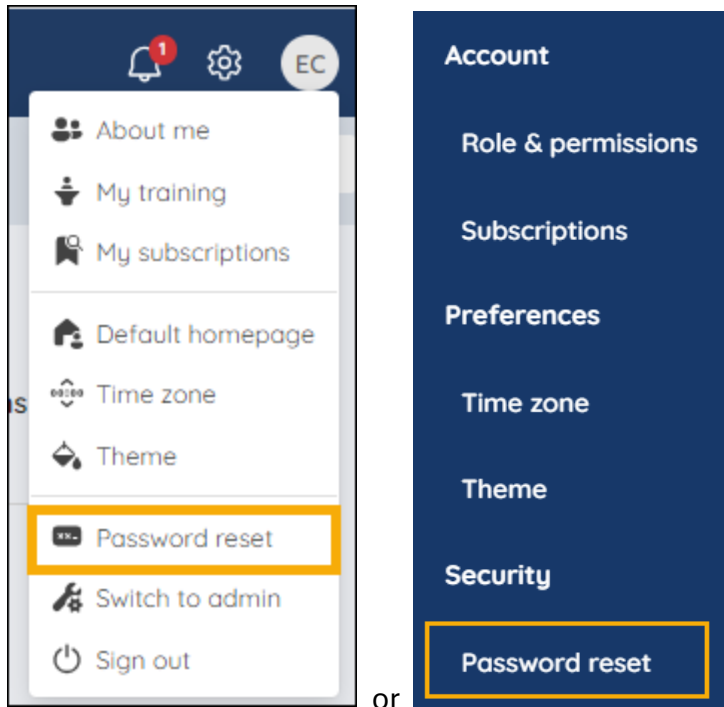

3. Enter the **Current password** (Required).
4. Enter a **New Password** (Required).

Important Notes:

- Passwords should be more than 8 (six) characters.
 - Contain upper- and lower-case letters.
 - Contain at least one number.
 - Contain a special character.
 - Passwords may **not** contain part of your email, username, first name, or last name.
5. Re-enter the password in the **Confirm new password** (Required).

Password reset

Current password *

New password *

- ✗ At least 8 characters long.
- ✗ Contains uppercase letters.
- ✗ Contains lowercase letters.
- ✗ Contains numbers.
- ✗ Contains special characters.
- ✓ Must not contain parts of your email, username, first name, or last name.

Confirm new password *

6. Click **Save**.
7. Once saved, Saber will prompt you to log in with your new password. It will also email you notifying you that your password has been changed.

Sign Out

The Sign out feature allows users to safely sign out of your account to protect your data and ensure secure access to the software.

Automatic Log out

If a user is inactive for more than 15 minutes, the application prompts you with an inactive session message. Users will have 60 seconds to respond to the message. If no response is received, the application automatically logs out.

You have been inactive for a while



For security reasons, your session is about to expire.

To continue your session please confirm that you are still here. You will be automatically logged out in: **29**

Stay logged in

Log out

For more information regarding the automatic log-out settings, refer to [Automatic timeout](#).